

Rotec Elbows (Elbow 90 Degree Bend)

Resin Type: Derakane 470

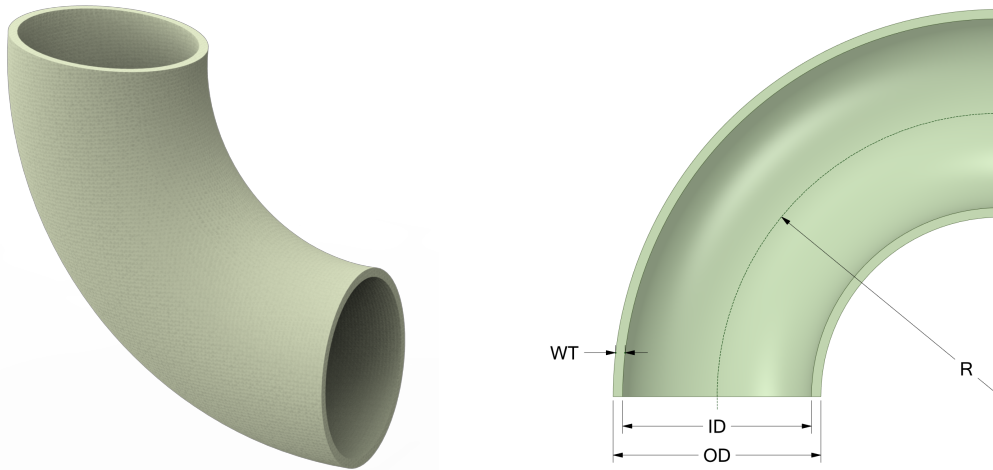

#	DN (mm)	Pmax (bar)	Bend Angle (deg)	ID (mm)	OD (mm)	WT (mm)	RF	R (mm)	Article Number
1	25	16	90	25	33	4	2.0	50	EMC90-25-16/PE
2	40	16	90	40	50	5	2.0	80	EMC90-40-16/PE
3	50	16	90	50	60	5	2.0	100	EMC90-50-16/PE
4	65	16	90	65	77	6	2.0	130	EMC90-65-16/PE
5	80	16	90	80	92	6	2.0	160	EMC90-80-16/PE
6	100	16	90	100	112	6	2.0	150	EMC90-100-16/PE
7	125	16	90	125	139	7	1.5	190	EMC90-125-16/PE
8	150	16	90	150	166	8	1.5	225	EMC90-150-16/PE
9	200	10	90	200	216	8	1.5	300	EMC90-200-10/PE
10	200	16	90	200	222	11	1.5	300	EMC90-200-16/PE
11	250	10	90	250	266	8	1.5	375	EMC90-250-10/PE
12	250	16	90	250	274	12	1.5	375	EMC90-250-16/PE
13	300	10	90	300	318	9	1.5	450	EMC90-300-10/PE
14	300	16	90	300	326	13	1.5	450	EMC90-300-16/PE

Disclaimer

Whilst every care is taken to ensure that the information on this website is complete and accurate, the Rotec Composite Group BV cannot accept responsibility for any omissions or inaccuracies or for any consequences arising therefrom. By using this website, the user accepts the terms of this disclaimer.

07-02-2024